

Zoom-150RGBW(LCA031)

Zoom-150 with special, unique and decent design, It combines honeycomb concept so that the item is far ahead in LED moving head domain. The item is named honeybee eye. It is high performance wash light, beam, pattern and special effect light as well. The zoom ranges from 4° to 60°. Beam and wash effect can be switched at will. Each LED can be controlled separated. It creates the colorful effect, the front lens may be infinitely rotation in forward and reverse which may be opened and closed like petals by adding colors and dynamic graphics. Each LED has individual color effect and color beam effect by light pipe by which the ray is toward lens.

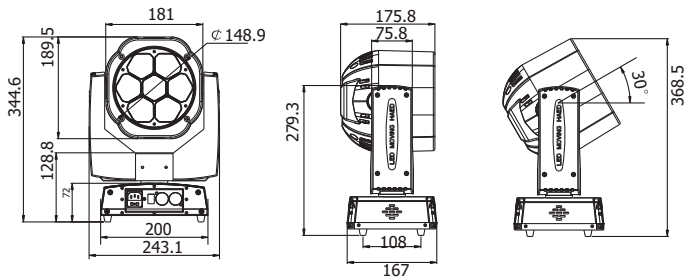

product specification

- Rate voltage: AC100V~240V, 50/60HZ
- Rate power : 150W
- LED qty: 7x15W high power 4 in 1LEDs
- LED drive current: 1000mA

- Zoom angle: 4° -60°
- IP class: IP20
- DMX modes: 25/55CH

Product feature

- XLR sockets input/output 3Pin
- IEC Power input,power output
- 3 kinds of control model: DMX512, Sound active,Master/slave
- LCD display screen
- Display screen can be turned upside down with 180° to fit the installation in different place
- Indoor operation temperature: -20° C~+40° C
- 2 DMX modes: 25/55CH
- dimmer:0-100% linear dimmer
- Pan/tilt:
 - ※ 16bit fine pan/tilt control
 - ※ Smooth and accurate locating
 - ※ Pan: 540° Tilt:210°
 - ※ Motor rotation in forward and reverse can be setting up
- Each LED can be controlled individually, rich colour

- The front lens may be infinitely rotation in forward and reverse
- Zoom angle :4° -60°
- 0-20HZ Strobe, pulse strobe, Asynchronous stroboscopic effect.
- Certification : CE , ROHS
- EMC:EN 55215 (2006) -EN 55015 A2 (2009)EN 61547 (2009) - EN 61000-3-2 (2006) EN 61000-3-2 A2 (2006) - EN 61000-3-3 (2008)
- LVD: EN 60598-1(2008)- En60598-2-17 (1989) EN 60589-2-17 A2(1991)

